

### BARRE FILETTATE IN RAME - Spessore 2 - 3 - 4 - 5 - 10 mm - Lunghezza 1000 e 2000 mm

Codice	Riferimento		Peso (Kg)	L (mm)	s (mm)	P (mm)	M
<b>BRF0990</b>	BRF 12X2X1000	10	0,22	12	2	18	M5
<b>BRF0995</b>	BRF 12X3X1000	10	0,32	12	3	18	M5
<b>BRF1000</b>	BRF 12X4X1000	10	0,42	12	4	18	M5
<b>BRF1005</b>	BRF 12X5X1000	10	0,49	12	5	18	M5
<b>BRF1010</b>	BRF 15X5X1000	4	0,64	15	5	25	M6
<b>BRF1015</b>	BRF 20X5X1000	4	0,84	20	5	25	M6
<b>BRF1016</b>	BRF 25X4X1000	4	0,80	25	4	25	M6
<b>NEW</b> <b>BRF1017</b>	BRF 25X5X1000	4	1,12	25	5	25	M6
<b>BRF1020</b>	BRF 32X5X1000	4	1,35	32	5	25	M6
<b>BRF1025</b>	BRF 12X4X2000	10	0,84	12	4	18	M5
<b>BRF1030</b>	BRF 15X5X2000	4	1,18	15	5	25	M6
<b>BRF1031</b>	BRF 15X5X2000 PC	4	1,16	15	5	18	M6
<b>BRF1035</b>	BRF 20X5X2000	4	1,66	20	5	25	M6
<b>BRF1040</b>	BRF 30X5X2000	4	2,49	30	5	25	M6
<b>NEW</b> <b>BRF1042</b>	BRF 32X5X2000	4	2,85	32	5	25	M8
<b>BRF1041</b>	BRF 32X5X2000-W	4	2,65	32	5	17,5	M6
<b>BRF1045</b>	BRF 30X10X1000	4	2,49	30	10	25	M8

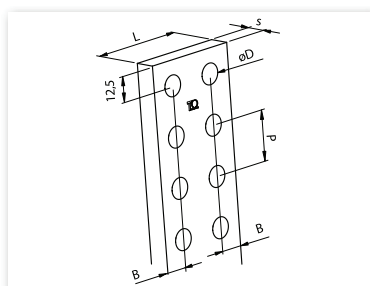
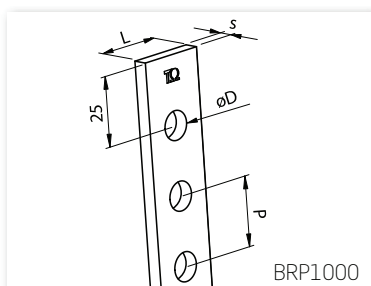

### BARRE PREFORATE IN RAME - Spessore 5 - 10 mm - Lunghezza 1750 mm

Codice	Riferimento		Peso (Kg)	L (mm)	s (mm)	P (mm)	D Ø (mm)	B (mm)
<b>BRP1000</b>	BRP 25X5	2	1,39	25	5	25	10,5	12,5
<b>BRP1005</b>	BRP 50X5	2	3,39	50	5	25	10,5	12,5
<b>BRP1010</b>	BRP 63X5	2	4,39	63	5	25	10,5	12,5
<b>BRP1015</b>	BRP 80X5	2	5,69	80	5	25	10,5	12,5
<b>BRP1020</b>	BRP 100X5	2	7,24	100	5	25	10,5	12,5
<b>BRP1025</b>	BRP 125X5	2	9,19	125	5	25	10,5	12,5
<b>BRP1030</b>	BRP 50X10	2	6,70	50	10	25	10,5	12,5
<b>BRP1035</b>	BRP 60X10	2	8,79	60	10	25	10,5	12,5
<b>BRP1040</b>	BRP 80X10	2	11,30	80	10	25	10,5	12,5
<b>BRP1045</b>	BRP 100X10	2	14,40	100	10	25	10,5	12,5
<b>BRP1050</b>	BRP 120X10	2	18,30	120	10	25	10,5	12,5